

The background of the slide is a photograph of a stone wall. The wall is constructed from large, irregular, light-colored stones. In the foreground, there is a patch of green grass and some bare soil. The lighting suggests it's daytime.

Columbus Metropolitan Library

Dublin Branch

75 N. High Street, Dublin, OH 43017

Basic Site Plan Review



COLUMBUS **METROPOLITAN LIBRARY**

Dublin Branch

Patrick Losinski, CEO
Columbus Metropolitan Library

Dublin City Council – April 24, 2017



#1 LIBRARY

1999

2006

2008



5 STAR LIBRARY

2008

2009

2010

2011

2012

2013

2014

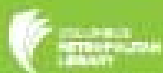

LIBRARY of the YEAR

2010



NATIONAL MEDAL FOR MUSEUM AND LIBRARY SERVICE

2011



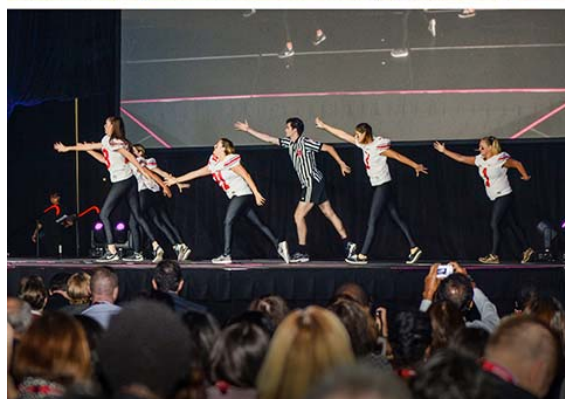
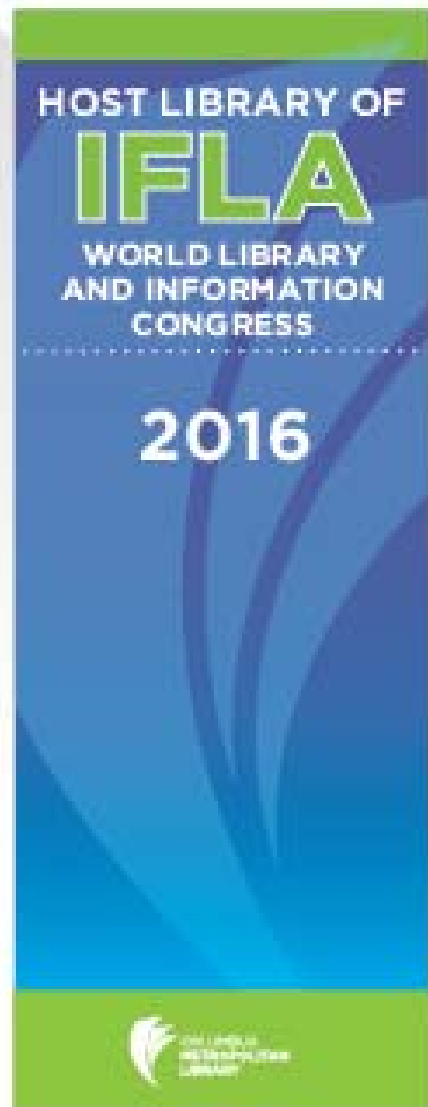

9 Guiding Principles

- ▶ **Transparency**
- ▶ **Flexibility**
- ▶ **Iconic Design**
- ▶ **Sustainability**
- ▶ **Technology**
- ▶ **Innovative Programming**
- ▶ **Customer Experience**
- ▶ **Young Minds**
- ▶ **Showcase Our Collection**





Dublin Branch Elevation: Current and Proposed

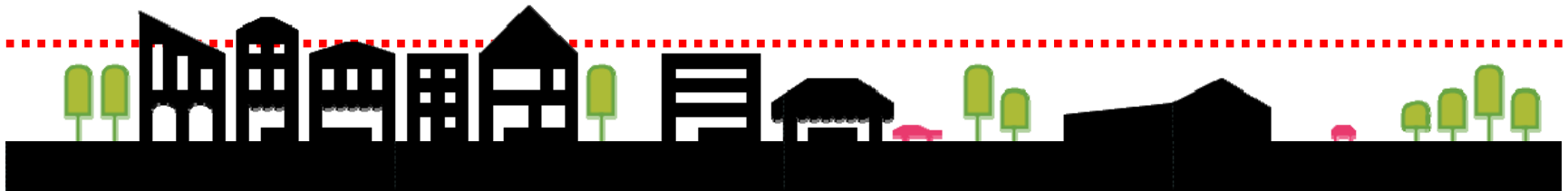

Plan Refinements

- ▶ Brick to stone base material
- ▶ Transitional sidewalk and landscape materials
- ▶ Create a “signature transition element”



AIA / ALA 2017 Most Beautiful Libraries



Columbus Metropolitan Library Whitehall Branch





East Boston Branch Library





**New York Public Library
Stapleton, Staten Island**



Boston Public Central Library



**Allan Price Science Commons & Research Library
University of Oregon**



National Library of Latvia





[Architects](#)

[Career](#)

[Advocacy](#)

[Events](#)

[Topics](#)

[Practice](#)





Columbus Metropolitan Library Main Library



Columbus Metropolitan Library Main Library

Events in Main Library's Reading Room



Jim Gill Concert, March 23



United States Citizenship Ceremony, April 12



Events in Main Library's Reading Room



Garth Stein Author Visit , April 9



Anticipated Schedule

- City Council basic plan review - 4/24
- ▶ Dublin Branch Fundraising – Spring 2017
- ▶ Design completion – Summer 2017
- ▶ Temporary location – Fall 2017
- ▶ Construction – November 2017
- ▶ Opening - 2019





Last Time:

CML System & Dublin Overview

Library Evolution

Great Libraries (Old + New)

Context (CML + Dublin)

Future Development

CML & Dublin: Overview

Current Dublin Branch

- ▶ Built in 1980 with addition in 1990
- ▶ Current Square Footage: 20,147 sq. ft.
- ▶ Current Parking Spaces: 119
- ▶ Fourth busiest branch in system



New Dublin Branch

- ▶ Proposed Sq. Footage: 41,000 sq. ft.
- ▶ City/library parking garage project
- ▶ Will become one of our largest branches



Library Evolution: Increasingly about People



ALONE



TOGETHER

Library Evolution: Inward to Outward Focus

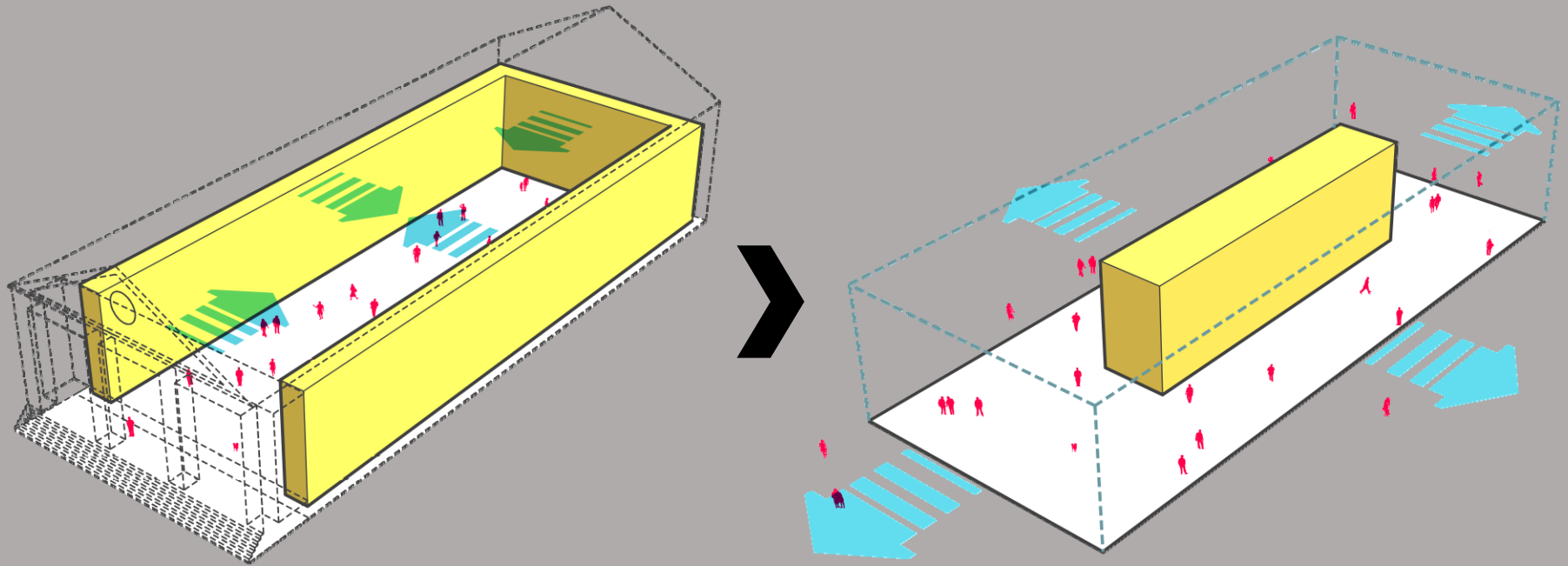

Great Libraries:

Established Contexts &
Contemporary Expression



Calgary Public Library: Calgary, Alberta Canada

CML + Dublin: Alignment

LIBRARY
GUIDING
PRINCIPLES

DUBLIN CITY
ASPIRATIONS
FOR THE LIBRARY

ICONIC DESIGN
SUSTAINABLE

ICONIC CONTEMPORARY DESIGN
SUSTAINABLE

TRANSPARENCY

CONTRIBUTE TO BRIDGE ST.

TECHNOLOGY

CONTEXTUALLY RELEVANT

KNOWLEDGE

REINFORCES WALKABILITY

INNOVATION

COMMUNITY CENTRIC

CUSTOMER EXPERIENCE

YOUNG MINDS

SHOWCASE COLLECTION

Future Development: Future Thinking



What we heard:

Be more responsive to the
context via the materials.

Provide more of a transition from
old to **new**.

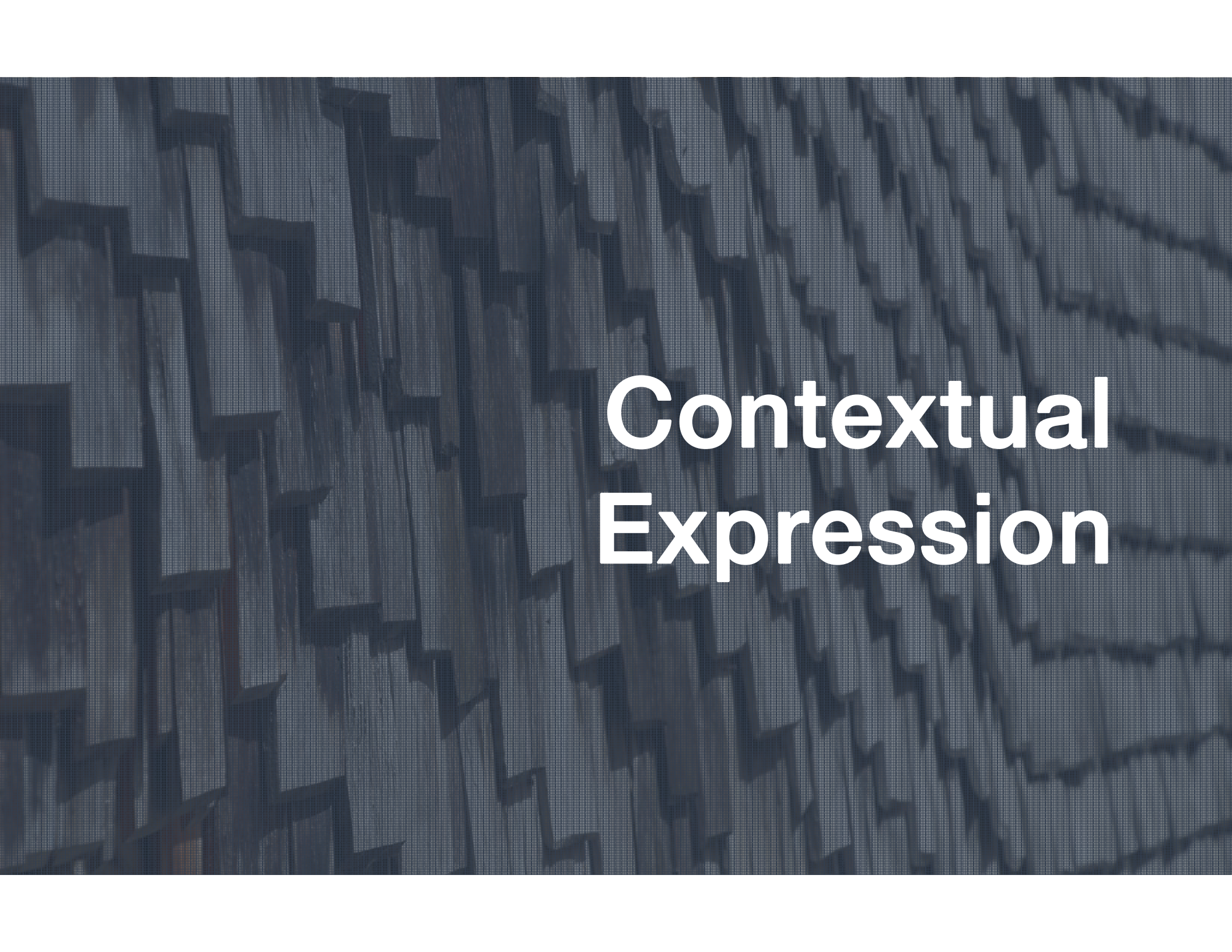

Contextual Expression



Chelsea Borough House Texture



Street Transparency



Riverview Wild Green



Veterans Park Dry Laid Wall



Shingled Metal Panel



Street Transparency



Wild Green



Masonry Base



Shingled Metal Panel



Street Transparency



Wild Green



Masonry Base



Shingled Metal Panel



Street Transparency



Wild Green

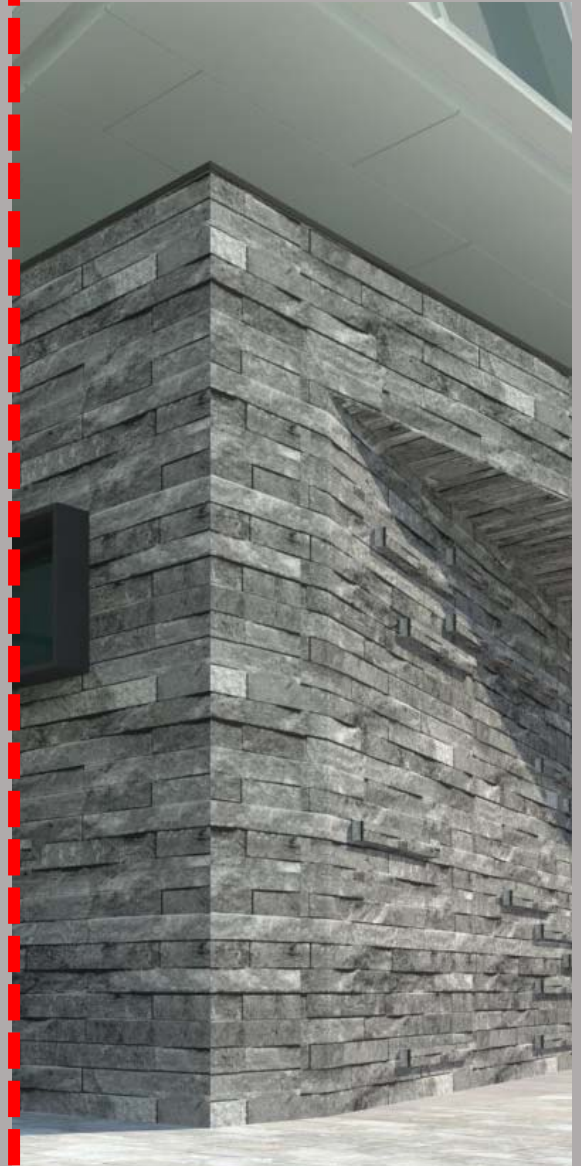

Masonry Base



Shingled Metal Panel



Street Transparency



Wild Green



Masonry Base

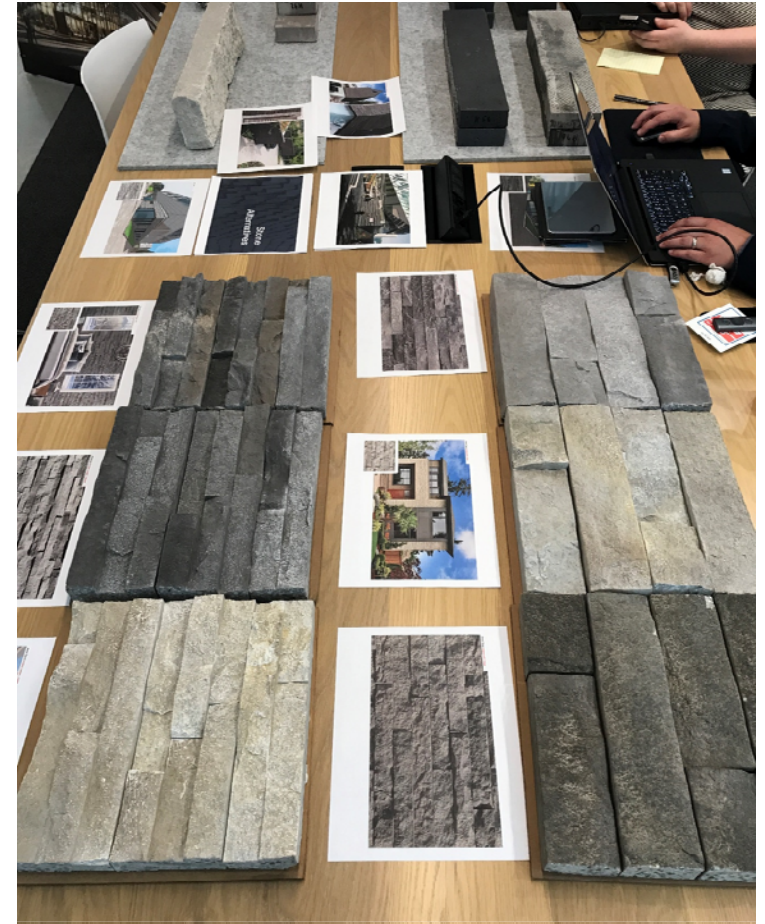

Base Material Evaluation



High Street and North Street (Street Trees on High Street Omitted for Clarity)



High Street and North Street (Street Trees on High Street Omitted for Clarity)







Transition Element
Zone

Overall Height
Reduction

Soft Greenery

Masonry Base
Material

Masonry Base
Material

Streetscape
integrated with
Dublin Standard

The background is a dark, textured image of a rural landscape. It features a series of stone walls in the foreground and middle ground, separating fields. In the distance, a small village with several buildings is visible under a dark, overcast sky. The overall tone is somber and historical.

Signature Transition Element

The background of the slide is a photograph of a stone wall, likely made of granite or a similar natural stone. The stones are arranged in a roughly horizontal pattern, with some showing signs of weathering and moss. A semi-transparent green mesh is overlaid on the entire image, creating a textured, digital effect. The text is white and positioned on the left side of the image.

Goal:

To establish a strong visual connection (or transition) between Dublin's historic identity and its dynamic future.

A photograph of a stone wall made of grey, rectangular stones, with a green, semi-transparent overlay covering the entire image. The text is white and positioned on the left side of the wall.

Guidelines:

Designed and fully integrated as part of the entire civic space.

Enhances and helps advance the overall design concepts.

Marks a transition from, or connection between Dublin's historic past and it's future.

Process:

- This element will be developed with an advisory committee that will represent a mix of civic leaders, CML leadership and NBBJ.
- Public input will be gathered at the onset of the project during concept design and again for input once design team has more refined proposals
- Recommended schedule:
 - Week of April 24th: Advisory Committee Kickoff
 - Week of May 1st: Public Input Session
 - Week of July 10th: Public Input Session
 - Late August: Presentation of Final Site Plan to Council.

Signature Transition Element

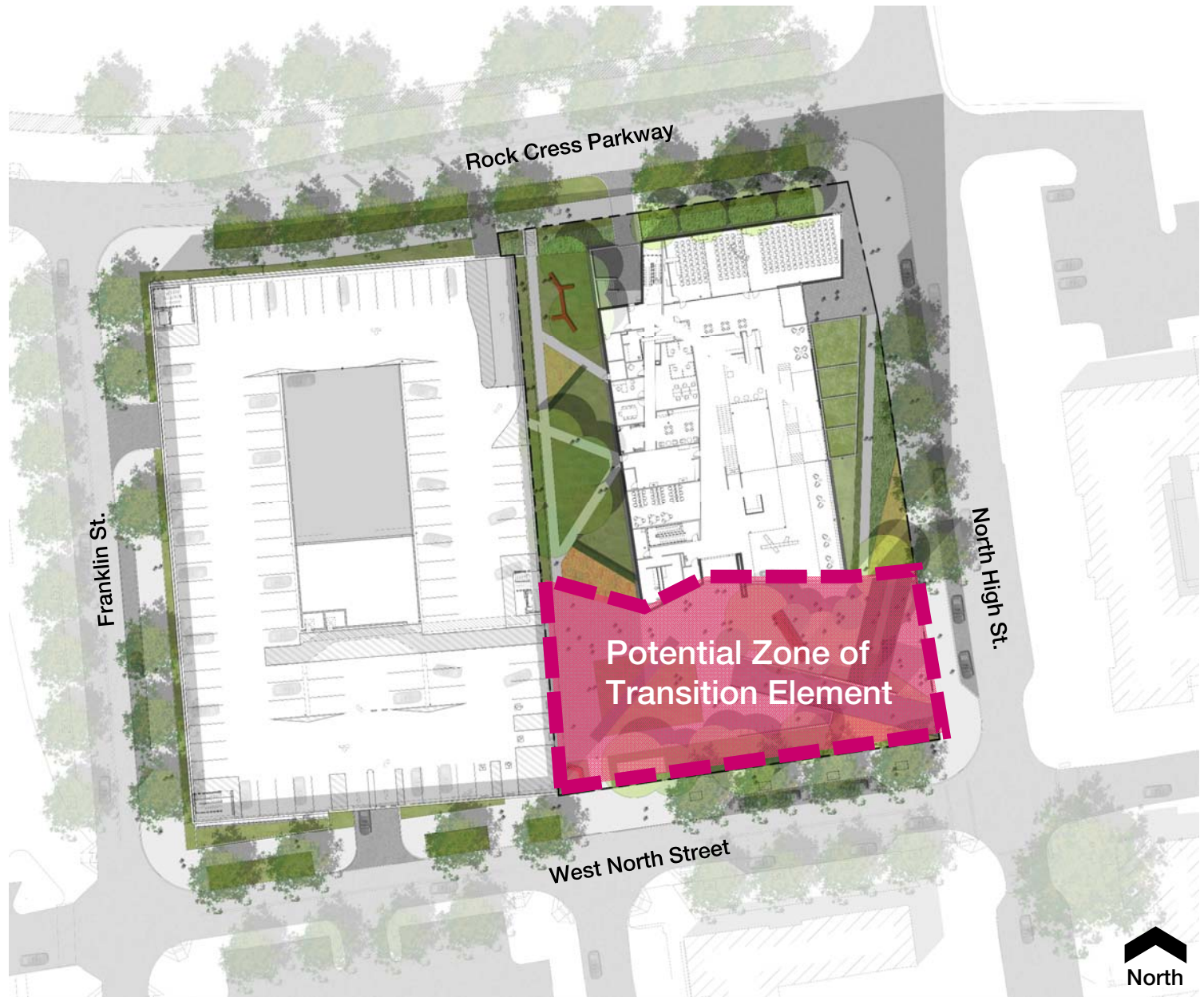



**Thank
You**